



SmartGen
ideas for power

HWP60A FORCED CIRCULATION HEATER USER MANUAL



SMARTGEN (ZHENGZHOU) TECHNOLOGY CO., LTD.



Chinese trademark

SmartGen English trademark

SmartGen – make your generator *smart*

SmartGen Technology Co., Ltd.

No.28 Jinsuo Road, Zhengzhou, Henan Province, China

Tel: +86-371-67988888/67981888/67992951

+86-371-67981000(overseas)

Fax: +86-371-67992952

Email: sales@smartgen.cn

Web: www.smartgen.com.cn

www.smartgen.cn

All rights reserved. No part of this publication may be reproduced in any material form (including photocopying or storing in any medium by electronic means or other) without the written permission of the copyright holder.

Applications for the copyright holder's written permission to reproduce any part of this publication should be addressed to SmartGen Technology at the address above.

Any reference to trademarked product names used within this publication is owned by their respective companies.

SmartGen Technology reserves the right to change the contents of this document without prior notice.

Table 1 - Software Version

Date	Version	Content
2020-12-31	1.0	Original release.



CONTENT

1. OVERVIEW	4
2. PERFORMANCE AND CHARACTERISTICS	4
3. SPECIFICATION.....	5
4. HEATER INSTALLATION.....	6
5. OPERATING INSTRUCTIONS.....	7
5.1. PANEL AND BUTTON.....	7
5.2. DISPLAY DESCRIPTION	7
5.3. PANEL DESCRIPTION	7
5.4. OPERATION DESCRIPTION	8
6. USE AND MAINTENANCE.....	9
6.1. VENT VALVE.....	9
6.2. WATER DRAIN VALVE.....	9
7. CONNECTIONS.....	10
8. CASE AND DIMENSIONS	11

SmartGen

1. OVERVIEW

HWP60A forced circulation engine water heater is composed of 3 parts (control section, water pump and water heater).

If the outside temperature is lower than 4°C, engine coolant and lubricant may condense into solid state and lose their lubricating and cooling properties during cranking, which can damage the engine. Thus engine heater should be installed to ensure normal starting and running of the engine when the outside temperature is lower than 4°C.

HWP60A forced circulation engine water heater combines the following features: cast stainless steel inner pipes and end closure with high corrosion resistance; heating and overheat light indicators; user-defined thermostat set point; dry heating and overheat protection.

This product is suitable for various engine with (25~50) L displacement.

Please login our company's official website (www.smartgen.com.cn) to select heaters.

2. PERFORMANCE AND CHARACTERISTICS

- The circulating water pump adopts special customized pump with stainless steel pump head;
- Microprocessor design of control section and PT100 temperature sampling. Coolant temperature can be set via the control panel. Four digital LED display, current coolant temperature and all kinds of set point temperature can be displayed clearly;
- Dry heating and overheat protection due to the inner overheating temperature detect switch;
- Separately control of water pump and water heater: power on the water pump and water heater synchronously, once the set temperature has reached, water heater will be powered off firstly, after 60s, following is water pump. The goal is to prevent heat concentration and significantly prolong water pump lifetime;
- Manually test the water heater and water pump are normal or not via panel button;
- Fine cast aluminum enclosure;
- Stainless steel inner pipes and sealed end closure;
- There is a water drain valve with seal ring on the bottom of the heater so as to be used when needed;
- There is one-way inlet valve on the water inlet;
- This product can work normally at -40°C temperature.

3. SPECIFICATION

Table 2 – Parameters Specification

Item	HWP60A
Rated Power	6000W
Rated Voltage	AC 420V
Rated Current	8.3A
Phase	Three phase
Engine Displacement	(25~50) L
Thermostat Range	Off: (5~99)°C On: (0~94)°C
Default Thermostat Range	Off: (40±2)°C On: (25±2)°C
Overheating Thermostat Range	Off: (95±3)°C On: (80±6)°C
Insulating Resistance	≥50MΩ
Electrical Strength	AC 1.5kV 1min
Inlet/Outlet Size	3/4"(Φ19.5mm)
Max. Water Pressure	0.5MPa
Pump Flow Velocity	40L/min (1.5m of lift)
Protection Level	IP44
Vibration Resistance	(5~8)Hz Amplitude±7.5mm Triaxial (8~500)Hz a=2g Triaxial
Shock Resistance	Half-sine Wave; a _{peak} =50g; Triaxial
Working Conditions	-40 °C~+70 °C
Storage Conditions	-40 °C~+80 °C
Case Dimensions	504 mm×255 mm×426 mm
Weight	15kg

4. HEATER INSTALLATION

Please install the heater vertically according to the diagram before use. Pay attention to the direction of heater inlet and outlet, and ensure that the heater position is below the lowest water level of the engine and that all the air is exhausted out of the heater and it is topped off with coolant.

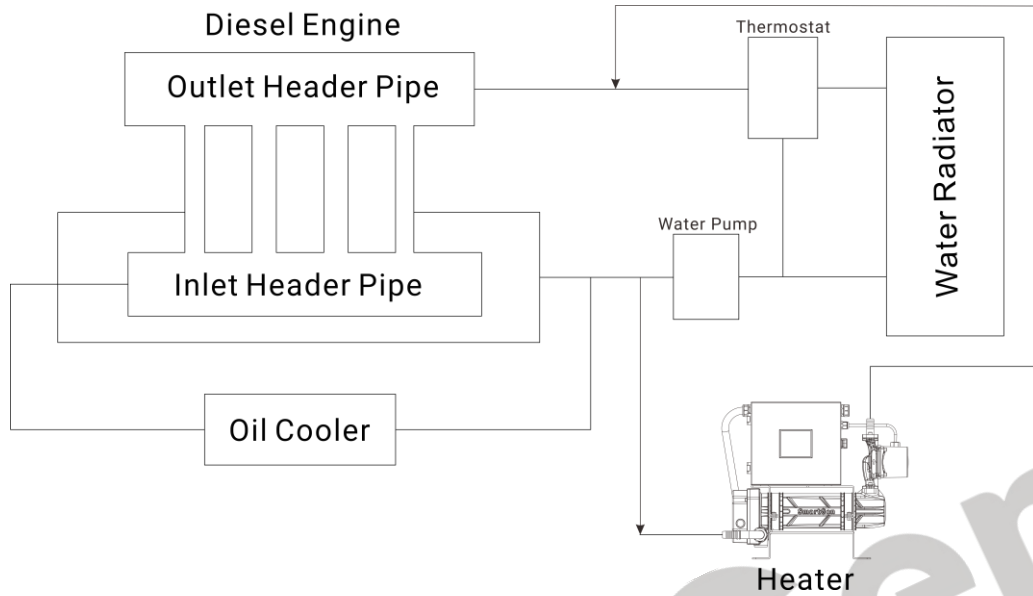

Fig.1 – Working Schematic Diagram

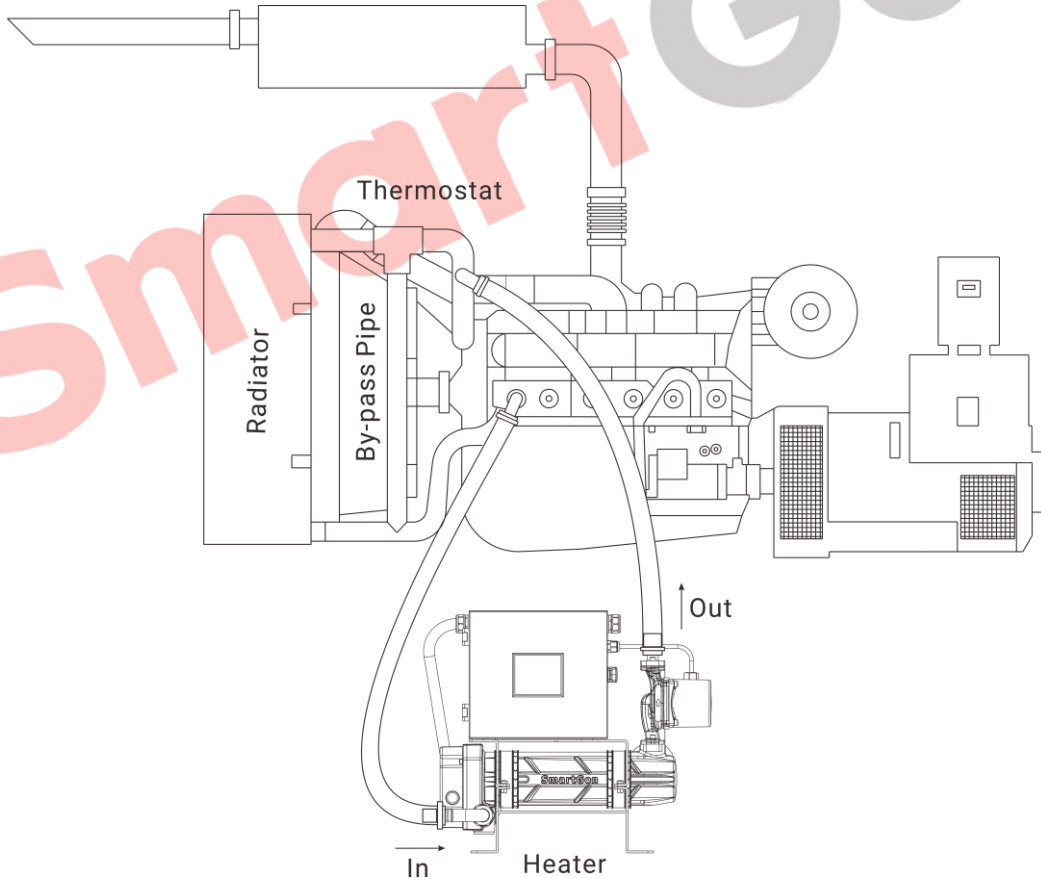

Fig.2 – Installation Diagram

5. OPERATING INSTRUCTIONS

5.1. PANEL AND BUTTON

Table 3 – Panel Display and Buttons

Button	Definition	Description
	Test	Pressing this button to test-run the machine.
	Lamp Test	All indicators will be illuminated when the button is pressed.
	Set	Pressing this button to set the temperature value.
	Turn Page	Pressing this button to scroll pages of the LED Nixie Tube and adjust the value.

5.2. DISPLAY DESCRIPTION

The heater is heating on when the “Heating” indicator is illuminated while the Thermostat is open and the heater stops heating when the “Overheat” indicator is flashing.

Temp. Display: OFF

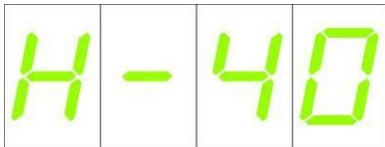

Temp. Display: ON

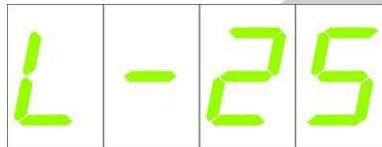

Temp. Display: Current Temp.



Alarm: Sensor Abnormal

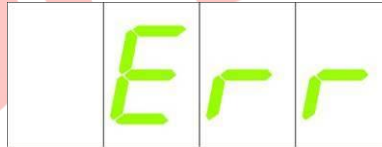

5.3. PANEL DESCRIPTION

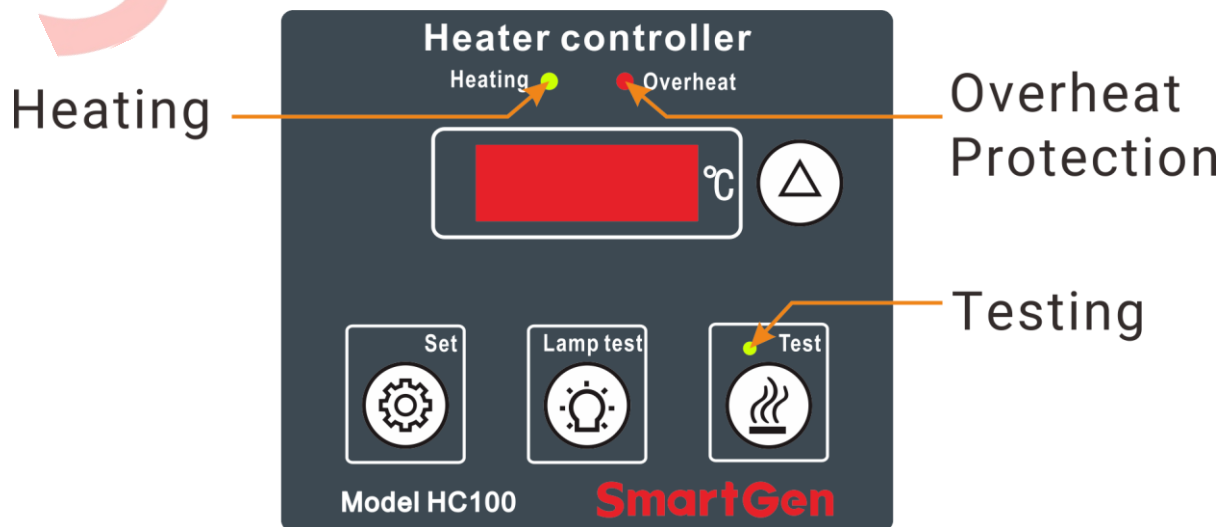

Fig.3 – Operation Panel Drawing

5.4. OPERATION DESCRIPTION

★Turn Page()

Using this button you can scroll pages of the LED Nixie Tube and adjust the value.



★Test()



If the water temperature has exceeded the preset "ON" temperature, pressing this button will test-run the heater, after 3s, it turns into Auto mode automatically.



★Lamp Test()

All indicators will be illuminated when the button is pressed.

★Set()

Pressing this button will enter into setting interface, as shown:  (Letter "H" means that it is the preset "OFF" temperature, here we take 40°C as example), the first digital is flashing and you can adjust it by pressing  button. Then press  button, the second digital will flash and the

adjust way is same as the first digital. Press , as shown:  (Letter "L" means that it is the preset "ON" temperature, here we take 25°C as example), the first digital is flashing and you

can adjust it by pressing  button. Then press  button, the second digital will flash and the adjusting way is same as the first digital. After doing these, press  button, the LED will back the current temperature. All the adjustment should be saved and not lost even when power is off.

6. USE AND MAINTENANCE

6.1. VENT VALVE

Before starting the machine, ensure that all the air is exhausted out of the heater and it is topped off with coolant, and make sure that the pump is full of water by using vent valve.

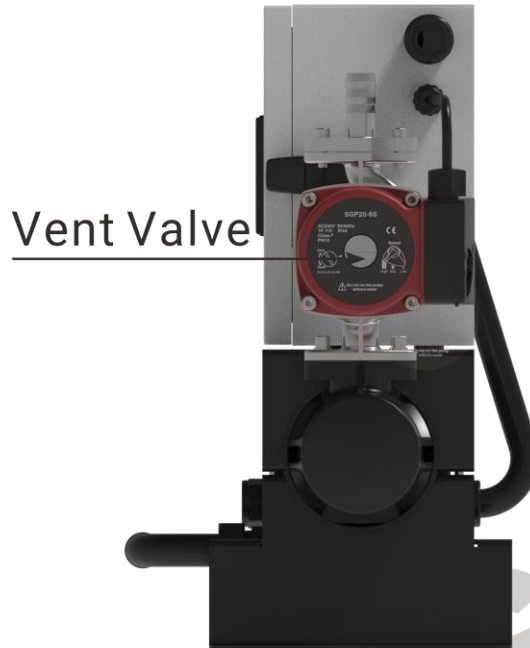

Fig.4 – Vent Valve Indicating Diagram

6.2. WATER DRAIN VALVE

If water is used, please drain it off when generator is stopped to avoid internal corrosion. Otherwise, the remaining water freezes when temperature is lower than 0°C, which can damage the enclosure.

Corresponding antifreeze is strongly recommended.

Earth line must be soundly connected to earth.

Drain valve: Can be opened or closed using hexagonal tools.

Unit: mm

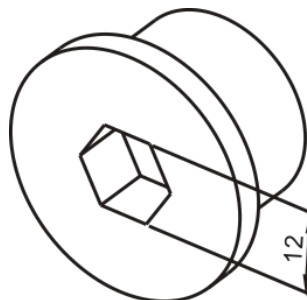

Fig.5 – Water Drain Valve

7. CONNECTIONS

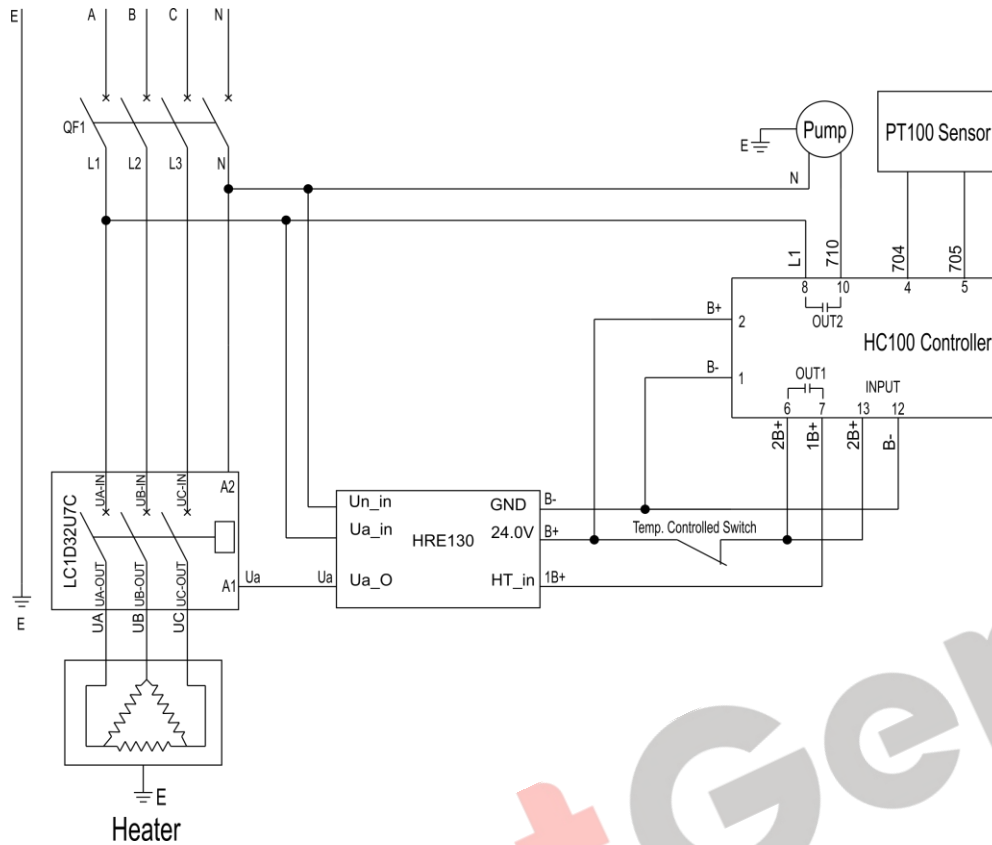

Fig.6 – HWP60A Diagram

Use 4mm² power cable for tie-in. Earth line must be soundly connected to earth.

8. CASE AND DIMENSIONS

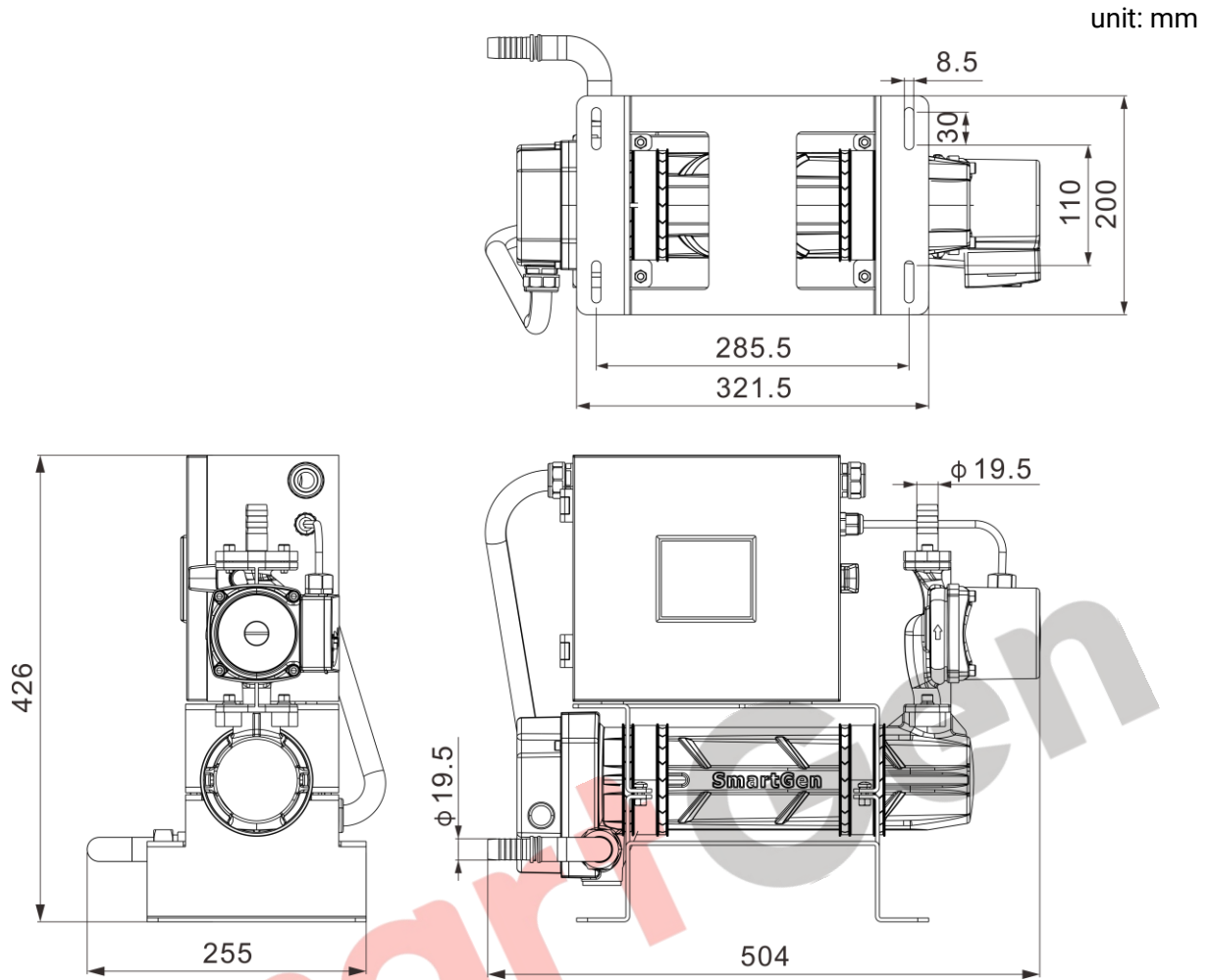

Fig.7 – Overall Dimensions

▲ **Note:** all the inlets/outlets connectors are Pagoda-shape.